

+/-12,532 SF INDUSTRIAL BUILDING

REAL PEOPLE, REAL SOLUTIONS®

KRAEMER FRONTAGE



AVAILABLE FOR LEASE

1351 N. KRAEMER BLVD
ANAHEIM, CA

- ±3,000 SF Office Space
- 16' Warehouse Height
- 2 Ground Level Loading Doors
- 400 Amps Power (verify)
- **LARGE FENCED YARD**
- **KRAEMER STREET FRONTAGE / SIGNAGE**
- Immediate Access to Orange (57) and Riverside (91) Freeways

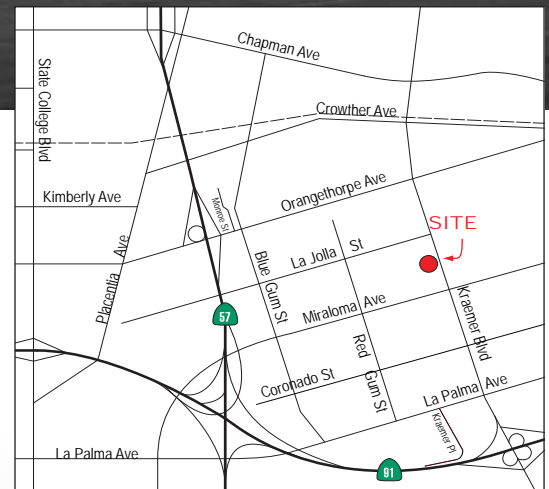

Southern California's Premier
Real Estate Marketing Team

Voit
REAL ESTATE SERVICES

**THE ZEHNER
DAVENPORT**
INDUSTRIAL GROUP



MICHAEL ZEHNER
Associate
714.935.2328
mczehner@voitco.com
Lic#01917963



MITCH ZEHNER
Executive Vice President
714.935.2307
mzehner@voitco.com
Lic#00882464



SETH DAVENPORT
Senior Vice President
714.935.2376
sdavenport@voitco.com
Lic#01413387

AVAILABLE +/-12,532 SF FOR LEASE

1351 N. KRAEMER BLVD, ANAHEIM

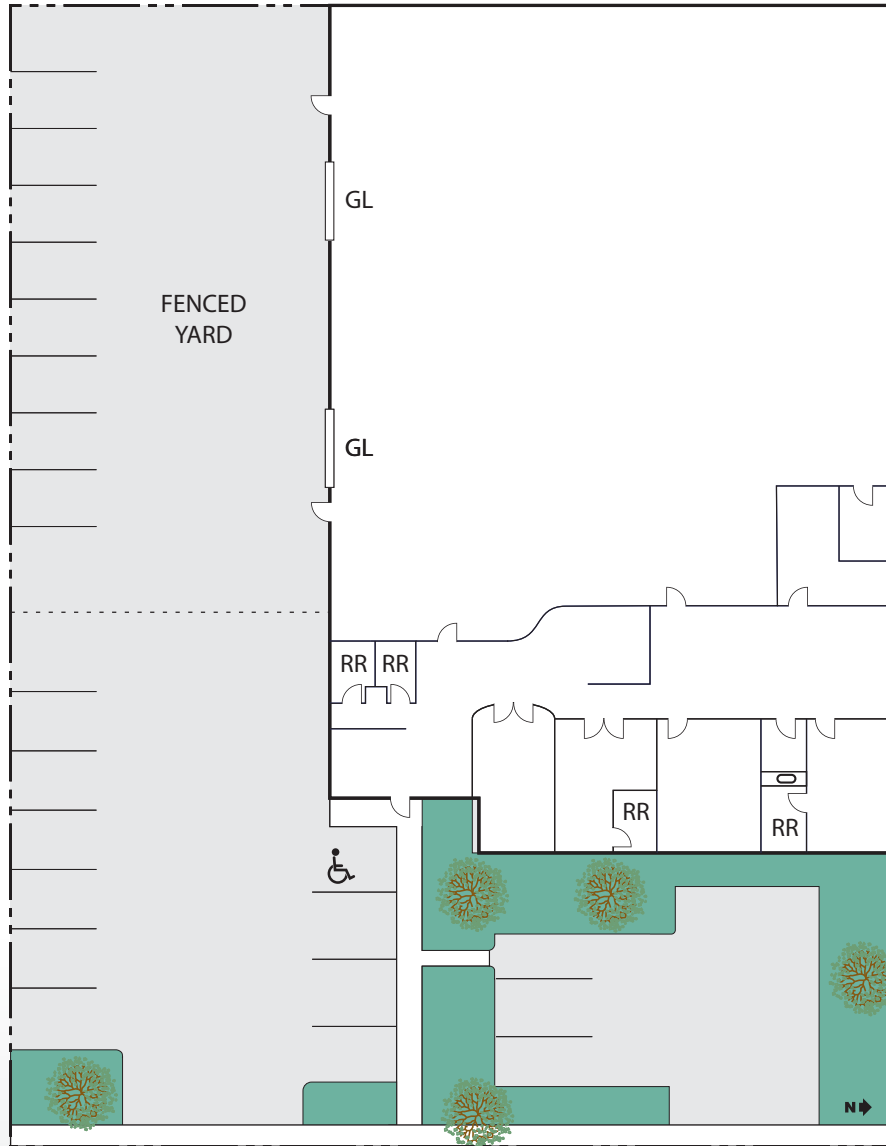

Voit
REAL ESTATE SERVICES

THE ZEHNER
DAVENPORT
INDUSTRIAL GROUP



MICHAEL ZEHNER
Associate
714.935.2328
mczehner@voitco.com
Lic#01917963



MITCH ZEHNER
Executive Vice President
714.935.2307
mzehner@voitco.com
Lic#00882464



SETH DAVENPORT
Senior Vice President
714.935.2376
sdavenport@voitco.com
Lic#01413387