

±17,855 SF FOR SALE OWNER / USER OPPORTUNITY IN ANAHEIM



TURNER CROSSING ANAHEIM

1331 Blue Gum Street, Anaheim, CA 92806

FEATURES

- An approximate 17,855 sq. ft. industrial building
- ± 1,379 sq. ft. of office space
- Fully Refurbished, Seismically Retrofitted, New HVAC and New Roof
- 1 Ground Level Loading Door
- 17' minimum warehouse ceiling (verify)
- 400 Amps 120-208 Volt Power; 3 Phase (verify)
- Orange (57) Freeway Signage and Exposure
- New Monument Signage along Blue Gum Street
- Large Exclusive Fenced Yard Area
- Fire Sprinklered
- Low and Reliable Power Electrical Rate
- Immediate Access to Costa Mesa (55), Riverside (91) and Orange (57) Freeways
- Highly Desirable North Orange County location with ideal proximity to infrastructure, ports, airports and a strong labor pool

TURNER
Real Estate Investments

TurnerREI.com

TURNER CROSSING ANAHEIM

1331 Blue Gum Street, Anaheim, CA 92806

SITE PLAN

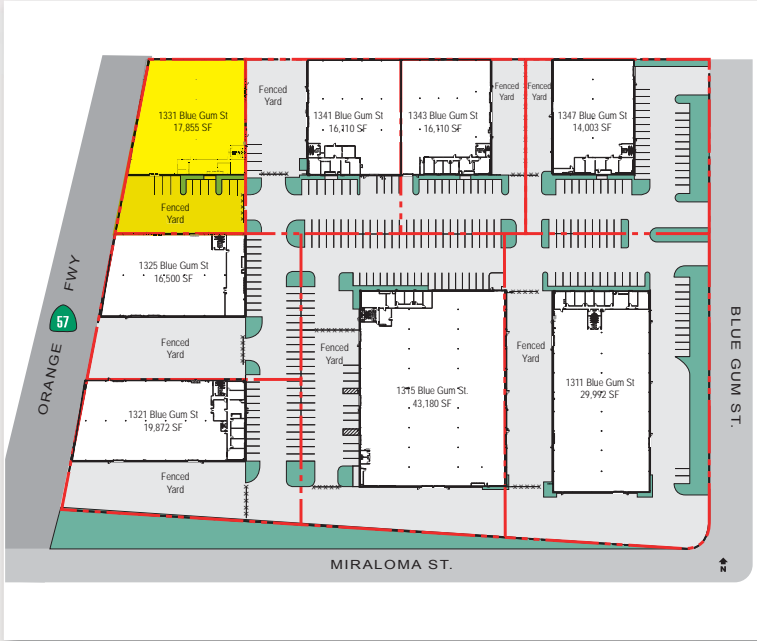

MAP

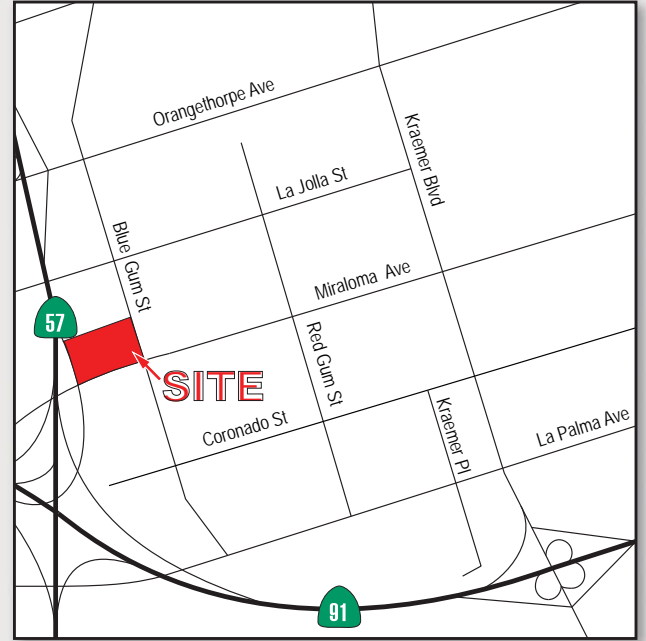

TURNER
Real Estate Investments

TurnerREI.com

SETH DAVENPORT
SENIOR VICE PRESIDENT
714.935.2376 direct
sdavenport@voitco.com
Lic# 01413387

ROB SOCCI
EXECUTIVE VICE PRESIDENT
714.935.2314 direct
rsocci@voitco.com
Lic# 00936016

MITCH ZEHNER
EXECUTIVE VICE PRESIDENT
714.935.2307 direct
mzehner@voitco.com
Lic#00882464

Voit
REAL ESTATE SERVICES