

For Lease

±32,363 SF

14701 FIRESTONE BOULEVARD, LA MIRADA

Firestone Freeway Business Center



Building Features

- ±32,363 sf high image industrial building
- ±6,735 square feet of 2 story high image office
- 24' warehouse clearance
- 800 amps (verify)
- 2:1 parking
- 3 ground level loading doors
- 4 dock high loading doors
- HVAC warehouse
- Showroom / corporate headquarters
- Excellent freeway identity / visibility ±174,000 cars per day along the Santa Ana (5) freeway
- Immediate freeway access via Valley View Avenue and Artesia Boulevard



SETH DAVENPORT

Executive Vice President
714.935.2376
Lic. #01413387

MITCH ZEHNER

Executive Vice President
714.935.2307
Lic. #00882464

Voit
REAL ESTATE SERVICES

**THE ZEHNER
DAVENPORT
INDUSTRIAL GROUP**

For Lease

±32,363 SF

14701 FIRESTONE BOULEVARD, LA MIRADA

Firestone Freeway Business Center

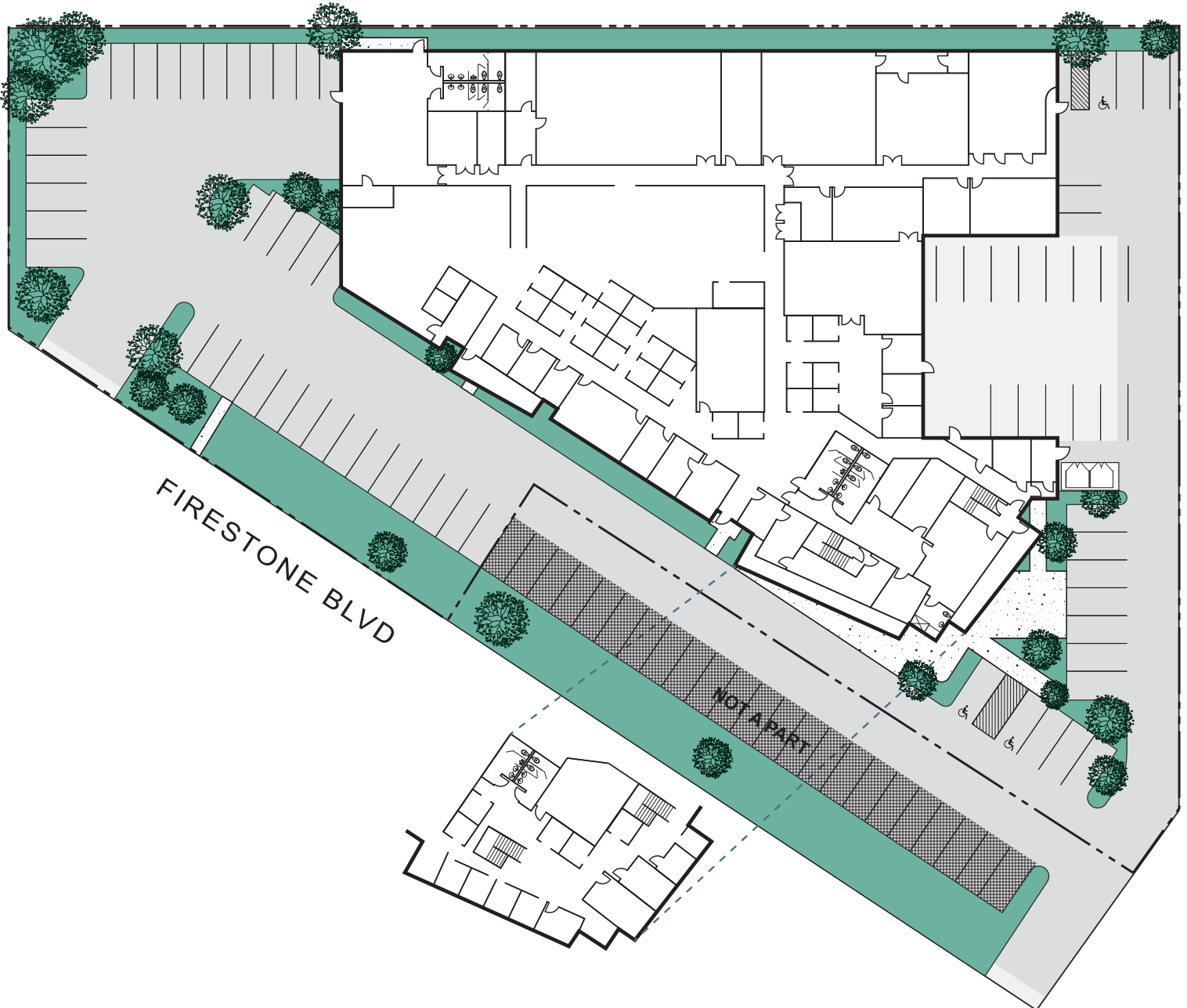

SETH DAVENPORT

Executive Vice President

714.935.2376

Lic. #01413387

MITCH ZEHNER

Executive Vice President

714.935.2307

Lic. #00882464



2400 E. Katella Avenue, Suite 750, Anaheim, CA 92806 • 714.978.7880 • 714.978.8329 Fax

Licensed as Real Estate Salespersons by the CA Bur of Real Estate. The information contained herein has been obtained from sources we deem reliable. While we have no reason to doubt its accuracy, we do not guarantee it. ©2017 Voit Real Estate Services, Inc. All Rights Reserved. License #01991785.

www.voitco.com | www.zehnerdavenport.com