



401 S. GRAND AVENUE SANTA ANA, CA

For Lease ±3,800 SF



PROPERTY DETAILS:

- Excellent Exposure & Signage on Grand Avenue
- Approximate 1,400 SF Office/Showroom Area
- Access to Dock High Loading Door
- Access to Ground Level Door
- Fire Sprinklered
- Large Fenced Yard Area
- Immediate Access to  &  Freeways
- Common Area Maintenance Charge of \$0.25 Includes, Telephone, Electricity, Water, Trash, Internet & All CAM Charges per the AIR Multi-Tenant Gross Lease



SETH DAVENPORT
Executive Vice President
714.935.2376
sdavenport@voitco.com
Lic#01413387

MITCH ZEHNER
Executive Vice President
714.935.2307
mzehner@voitco.com
Lic#00882464

Voit
REAL ESTATE SERVICES

**THE ZEHNER
DAVENPORT**
INDUSTRIAL GROUP

401 S. GRAND AVENUE SANTA ANA, CA

For Lease ±3,800 SF

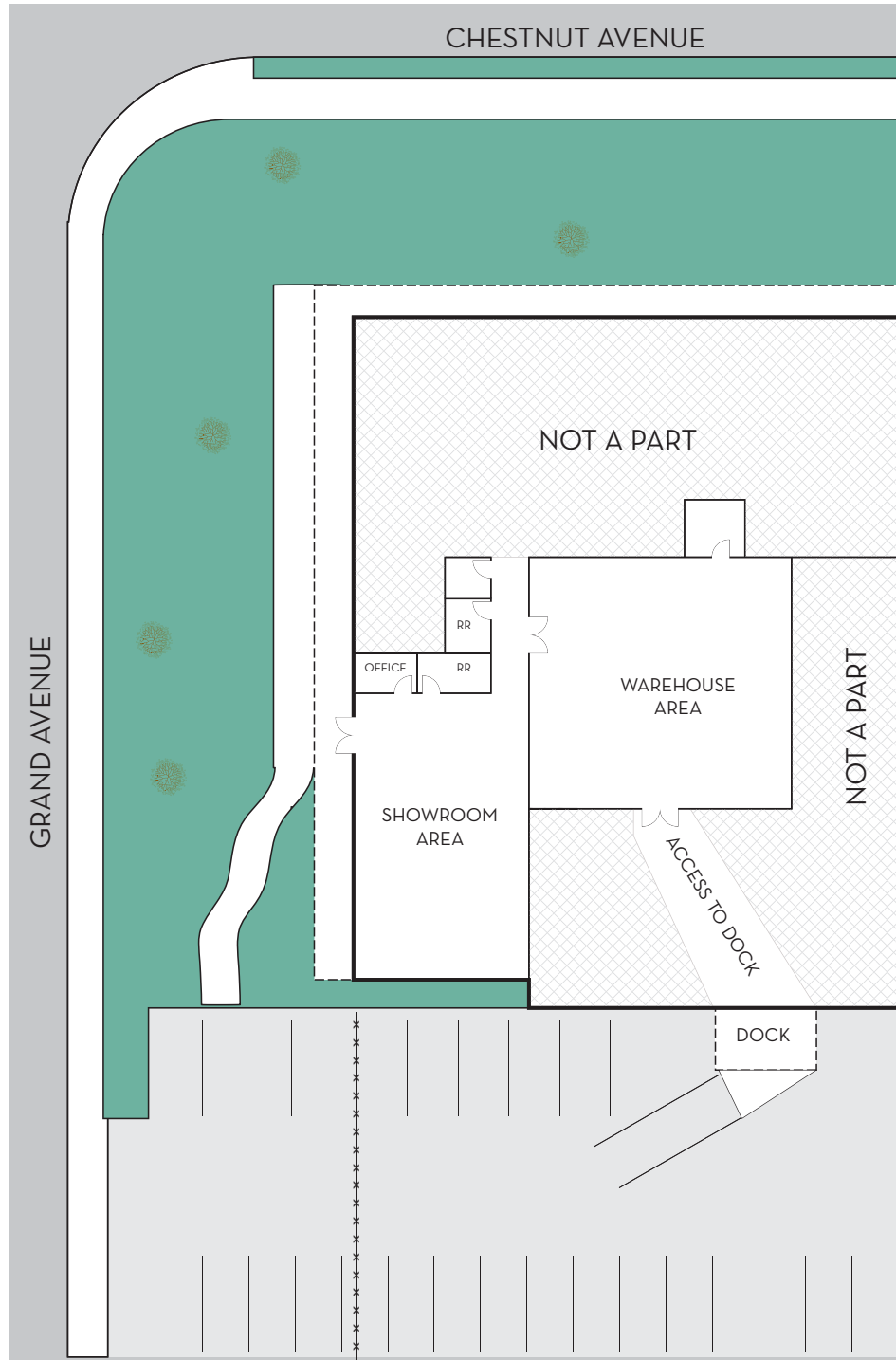

* Floor Plan Not to Scale

SETH DAVENPORT
Executive Vice President
714.935.2376
sdavenport@voitco.com
Lic#01413387

MITCH ZEHNER
Executive Vice President
714.935.2307
mzehner@voitco.com
Lic#00882464

Voit
REAL ESTATE SERVICES

**THE ZEHNER
DAVENPORT**
INDUSTRIAL GROUP